



LOAD KING TRAILERS

Model 605 LFM OF

P.O. Box 427
701 E. Rose ST.
Elk Point, S.D. 57025
USA

Phone (605) 356-3301
Fax (605) 356-3268
Toll free (888) 264-5522
www.loadkingtrailers.com

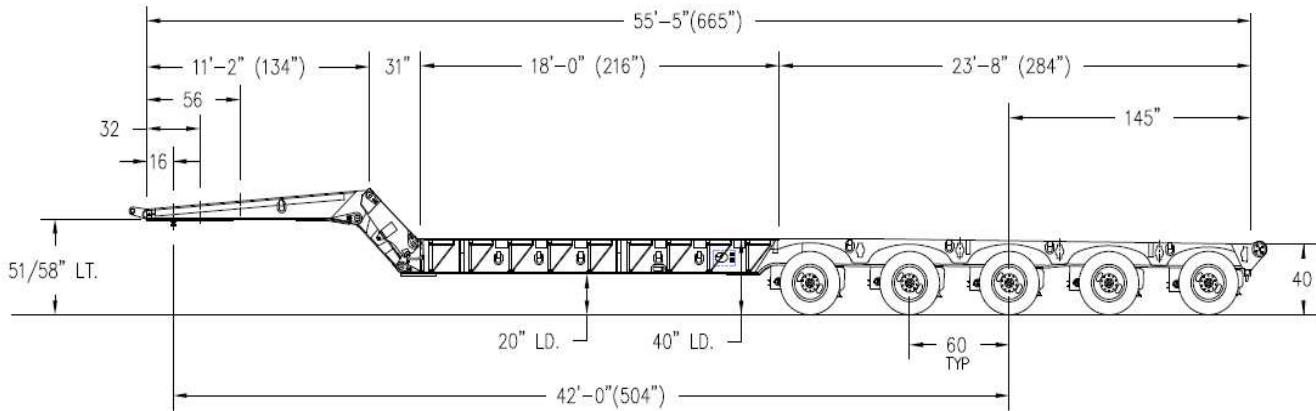

General Specifications

Dimensions

- 60 ton capacity in 10 foot load concentration at 60 miles per hour
- 100,000 / 80,000 psi yield strength steel construction
- 31,700 lb estimated base trailer weight
- Overall length 56' 3" w/standard specs incl. tail roller but excluding front lift eye
- 11 foot 2 inch gooseneck upper length
- 124 inch swing clearance with alt at 110" and 86"
- 18 foot deck length
- 102 inch deck width- pipe pockets add to deck width
- 39 inch loaded deck height
- 19 inch loaded ground clearance
- 51 inch & 58 inch 5th wheel heights

Gooseneck- Mechanical Operation

- Low profile gooseneck with parallel links
- 6" lift eye and tail chain hook
- Cable roller at rear of gooseneck-full width
- Upper flange reinforcing on gooseneck beams
- Linkage gooseneck lock pins located on both sides of trailer
- 7° approximate gooseneck loading angle
- 6 inch tapered nose piece with lift eye
- Full wood decked gooseneck
- 1 pair D rings on Gooseneck

Deck

- Level deck design
- Perimeter design full depth 20 inch cambered deck beams
- Crossmembers designed for center loading in gooseneck, drop and deck

Deck (cont.)

- 9 pr full depth swing out outriggers per side- yokes only, brackets optional
- 2 inch Apitong full width decking-double screwed
- 10 D-rings evenly spaced (6 pair)
- Outer pipe pockets- Five pair 1-5/8" I.D. Standard Location
- Inner pipe pockets- Two pair 3-3/4" I.D. Standard Location
- Flag pockets front of deck and rear of trailer
- Upper flange reinforcing between outrigger yokes

Subframe

- Five axle Air ride suspension
- Manual height control ahead of axle 1.
- Tail Roller- 8-5/8" x 1" thick cold rolled steel w/ spherical bearing & Support Rollers
- Live tail Roller to sit 1-1/2" above wheel cover
- Pipe pockets outboard tail roller- 1-5/8" ID set at angle
- Five 25,000 lb axles with 60" axle spacing
- Twenty 255/70 R 22.5 tires
- Twenty 8.25 x 22.5 hub piloted budd type disc wheels with oil seals
- Weld on wheel covers-flat
- 16½ inch x 7 inch spring brakes on 2 axles
- Auto slack adjusters
- HD rear bumper
- D rings at ends of full bolster (2 pr) and on tail gate (1 pr)

Other

- Mid-turn signal and clearance light
- DOT rubber mounted seal beam lights with modular wiring harness
- Mud flaps
- Red and white conspicuity striping
- Shot blast, primed and painted Black polyurethane

**Operating Pressure: Wet kit System requirements
3,000 psi at 10 gpm. All weights are +/- 3%**

**All specifications are subject to change without notice
Drawing May show optional equipment - Rev 100117**